

34 Home Park House South Street , Farnham, GU9 7RU

A well presented first floor double bedroom retirement flat located at the rear of this popular development situated in the heart of Farnham town. The flat has in recent years had a new kitchen and shower room fitted. No onward chain.

Price Guide £125,000

34 Home Park House South Street , Farnham, GU9 7RU



- Entry phone system
- Double bedroom with wardrobe cupboard
- Rear garden view
- No onward chain
- Sitting/dining room
- Hall with storeroom
- Communal parking and gardens
- Modern kitchen
- Shower room
- Residence sitting room and laundry room



[Directions](#)



Floor Plan

FIRST FLOOR
448 sq.ft. (41.7 sq.m.) approx.

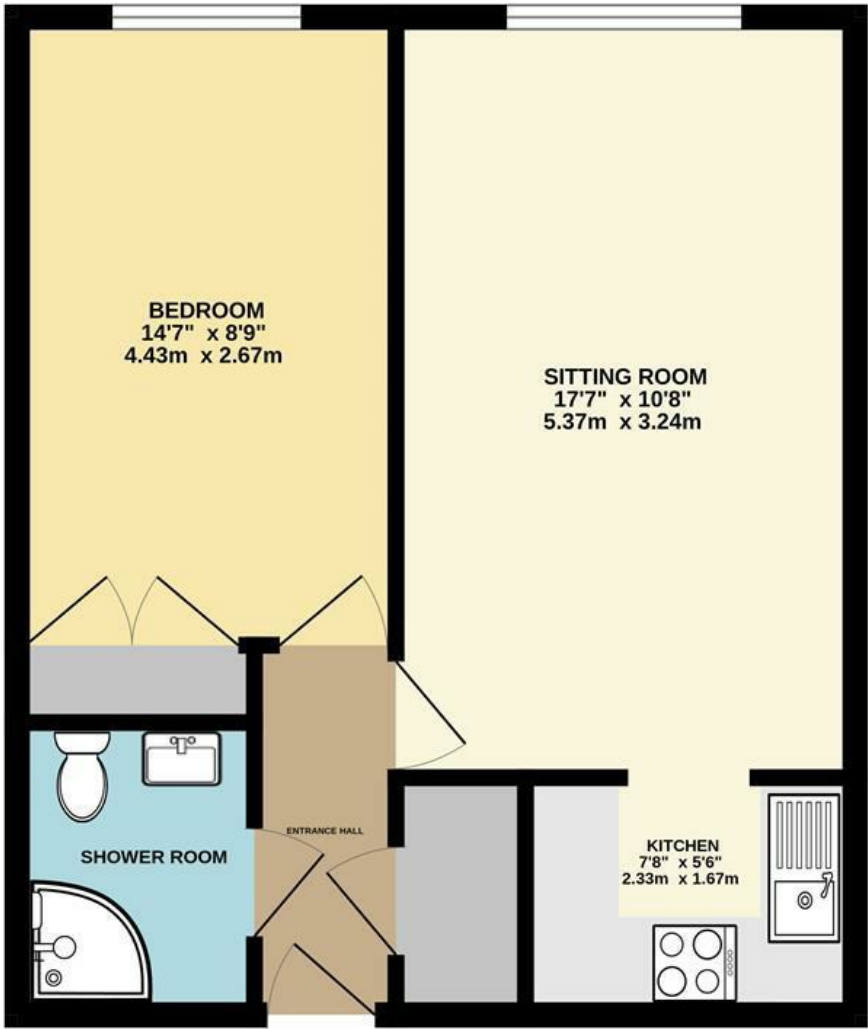

TOTAL FLOOR AREA : 448 sq.ft. (41.7 sq.m.) approx.
Whilst every attempt has been made to ensure the accuracy of the floorplan contained here, measurements of doors, windows, rooms and any other items are approximate and no responsibility is taken for any error, omission or mis-statement. This plan is for illustrative purposes only and should be used as such by any prospective purchaser. The services, systems and appliances shown have not been tested and no guarantee as to their operability or efficiency can be given.
Made with Metropix ©2025

These particulars, whilst believed to be accurate are set out as a general outline only for guidance and do not constitute any part of an offer or contract. Intending purchasers should not rely on them as statements of representation of fact, but must satisfy themselves by inspection or otherwise as to their accuracy. No person in this firms employment has the authority to make or give any representation or warranty in respect of the property.

